

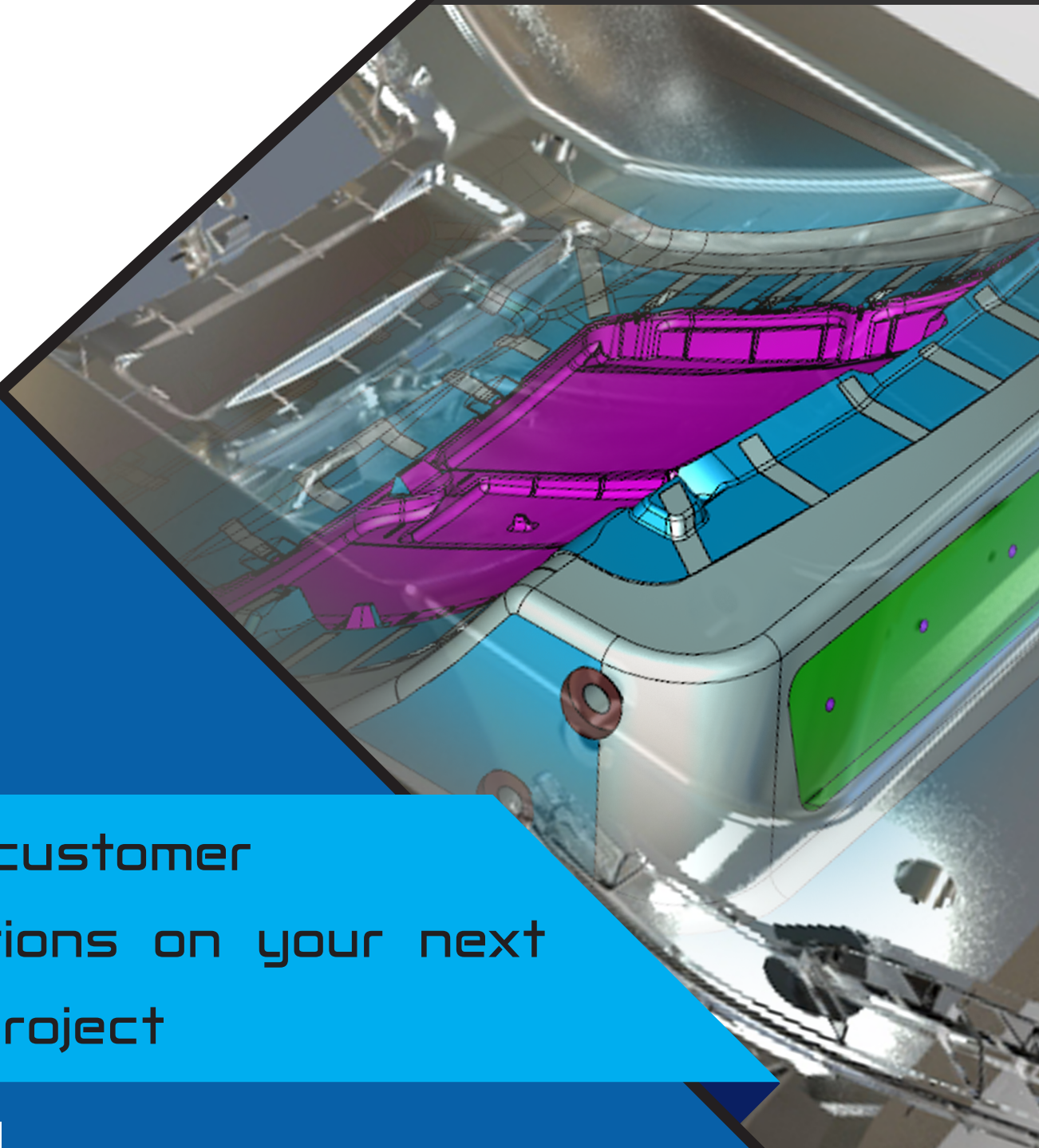

KEYCREATOR®

Unconstrained CAD/CAM

KUBOTEK®



Exceed customer
expectations on your next
design project

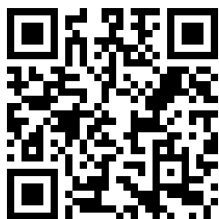

kubotek3d.com/keycreator

KeyCreator CAD/CAM means fast and flexible design and manufacturing.

Precise curve construction	Extensive CAD import/export	Complete visualization
Primitive, Boolean & swept solids	Optional part references	Assembly animation
Associative drawings	Feature-based editing	Standard parts libraries
Standards-based	Surface modeling	3D planes, vectors, and lights
Dimensioning/drafting	Measurement and inspection	NC toolpaths

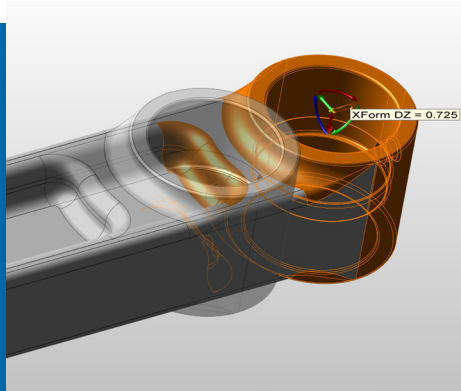

Standard Level – Uncommonly Practical Design

KeyCreator functions allow users to solve unpredictable problems quickly because sketches and 3D models are not bound by the history of operations or constraints used to create them. The simplicity of KeyCreator files allows initial unstructured concepts to gradually grow into complex assemblies.

"We are picking up jobs that we used to pass by with the confidence we have gained with KeyCreator. It has increased our profitability also by reducing rework and scrap."

Tim H., VP Redline Precision

"I don't have to worry about "design intent" or spend countless hours pre-thinking the build (so as to put features in the "proper" order). Nearly as quick as an idea comes to mind, the model begins to take shape."

Michael Dean, Lavelle Industries, Inc.

Pro Level – Quickly Re-use Design Data from Anywhere

KeyCreator import functions, direct solid editing and hybrid solid/surface/wireframe tools support the reuse of 3D models and drawings from any enterprise-targeted CAD software. This makes it the ideal program for design and manufacturing specialists that support numerous customers or pull together design information from multiple sources.

"I use it to easily create contoured parting lines for complicated molds. There are times when I am in a meeting that I take engineers models from other cad systems and change them right in front of them to make them moldable. They tell me "that would have taken me hours to change, and you just did it in minutes.""

Brian J., KeyCreator customer

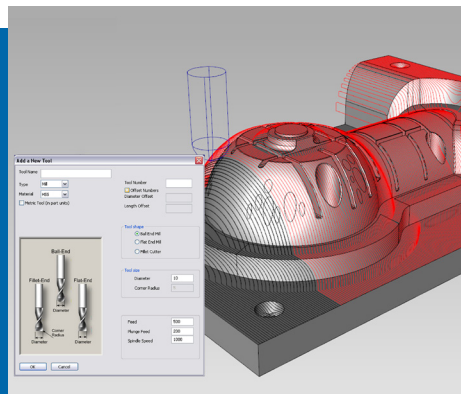
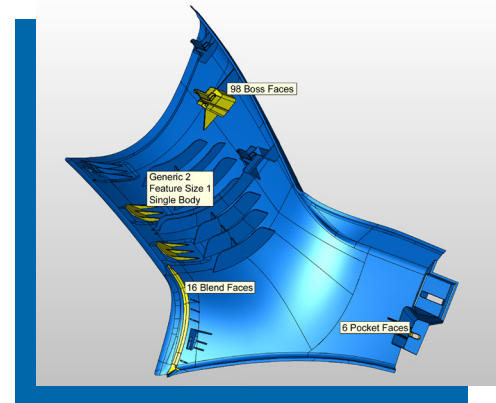

Max Level – Software Tool Chest of Master Craftsman

For professionals that do it all from design to build KeyCreator 2 & 3 axis CAM functions provide fast toolpath generation within the same interface and file as the design.

For more information:
kubotek3d.com/keycreator

